

S-265

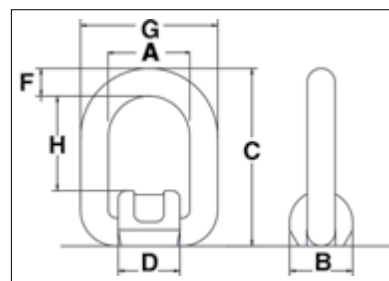

- Widely used on farm machinery, trucks, steel hulled marine vessels and material handling equipment.
- Forged link and bracket — Quenched & Tempered.
- Excellent welding qualities.
- Reference American Welding Society specifications for proper welding procedures.



APPLICATION AND WARNING INFORMATION
SECTION 17

S-265 Forged Link

Working Load Limit (t)		Stock No.	Weight Each (kg)	Dimensions (mm)								Minimum Fillet Weld Size (mm)
Design Factor 5:1	Design Factor 4:1			A	B	C	D	F	G	H		
1.0	1.2	1290839	0.40	43	40	79	36	13	69	38	3	
2.5	3.2	1290848	0.80	49	48	96	41	18	85	44	3	
4.2	5.3	1290857	1.50	56	61	128	48	22	100	63	6	
6.4	8	1290866	2.70	73	73	151	65	26	125	73	6	
12.0	15	1290875	5.90	100	90	194	90	34	168	95	8	